

# MALDIVES LAND SURVEY AUTHORITY

MINISTRY OF HOUSING AND INFRASTRUCTURE  
Office (PABX): +(960) 3004300, Fax: +(960) 3004254  
Email: survey@housing.gov.mv  
Web: www.surveyofmaldives.gov.mv,  
Ameenee Magu, Maafannu, Male', 20392, Maldives.



CONTROL POINT DETAILS	Station Number	PSM 5878
Coordinate Information		
Geodetic	Grid	
WGS 84	UTM Zone 43	
Lat: 5°14'07.22832"N	E:	297022.316m
Long: 73°10'06.99292"E	N:	578974.728m
Ellp Height: -87.038	Orth Height:	+1.345
Island Name: B.Dhandhoo, Maldives	Date:	25th October 2022

## Monument description & method of survey:

- Monument Type A as in Technical Brief
- Stainless steel plate fixed to concrete by Four bolts
- Horizontal coordinates fixed by GNSS Static survey.
- Vertical height corrected using tide prediction data ( Hulhule )
- PSM 5878 is at ground Level

## General site condition & access:

- Easily accessible area with wide angle of sky visibility
- Located at South East side of the island.
- Situated on south east side Vegetation line.( 4m from a dead coconut Palm)

Owner: DHANDHOO HOLDINGS PRIVATE LIMITED

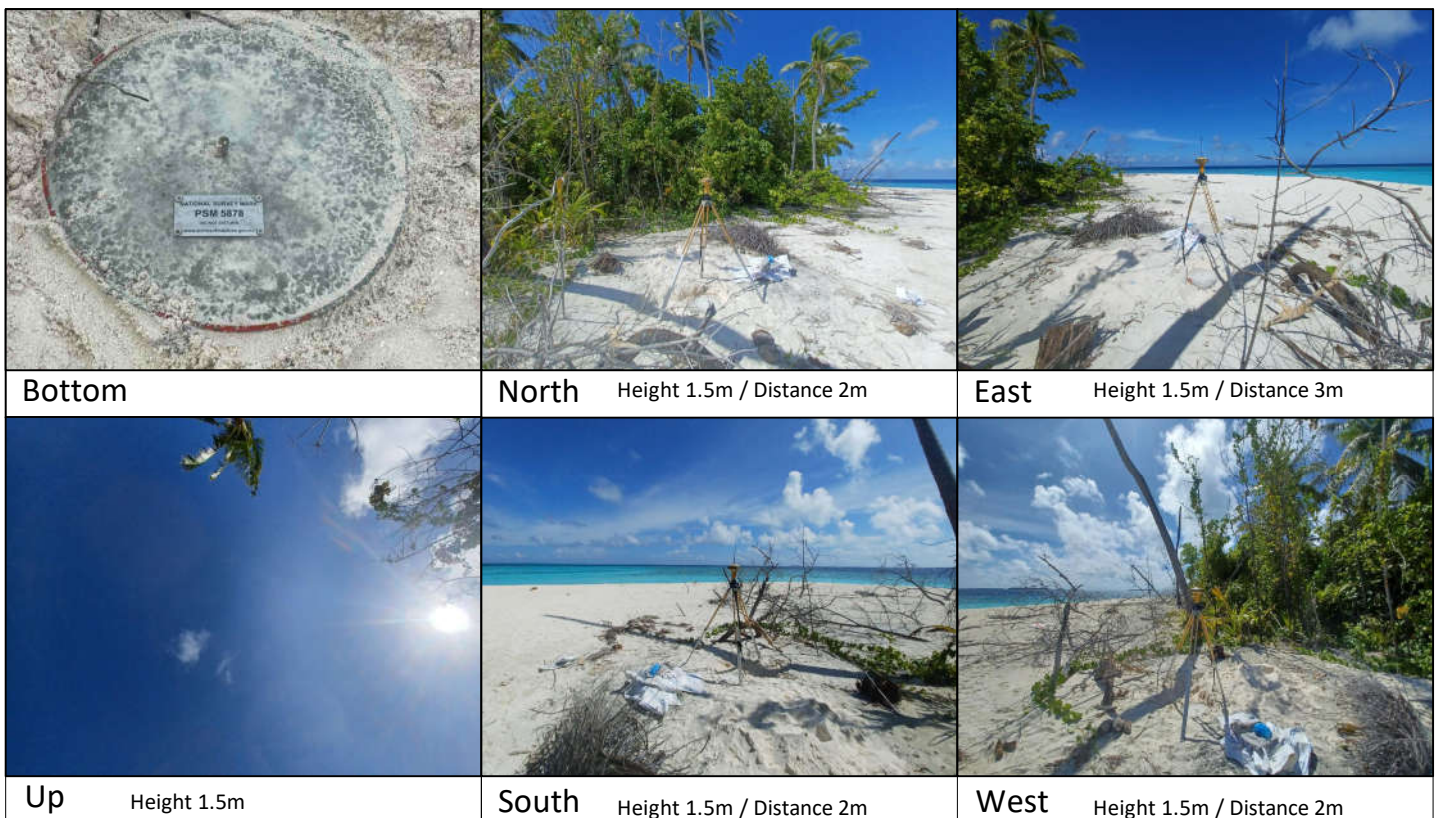

**SITE INFORMATION**

Station Number

P	S	M	5	8	7	8
---	---	---	---	---	---	---

**Station Horizon Mask**

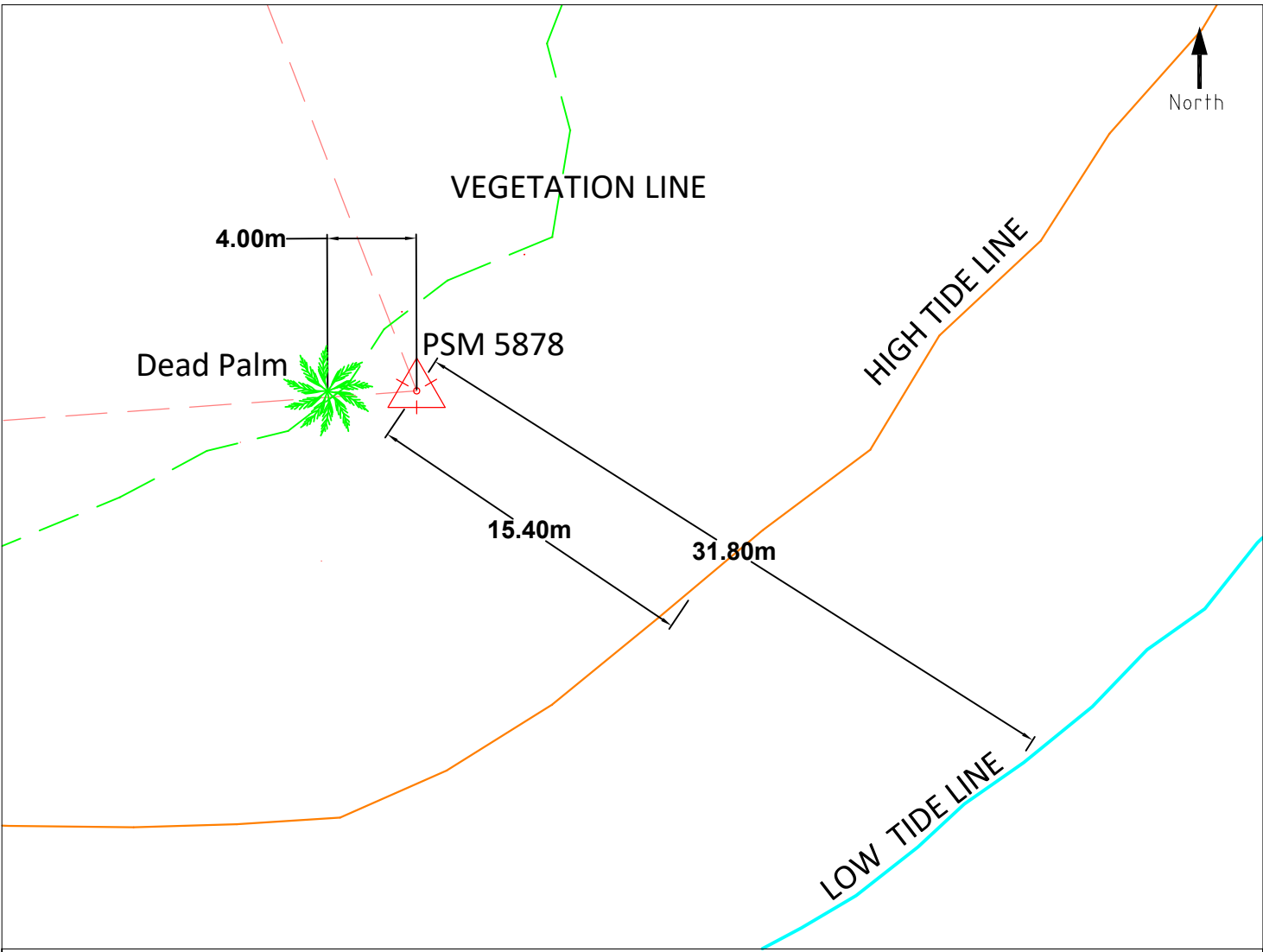
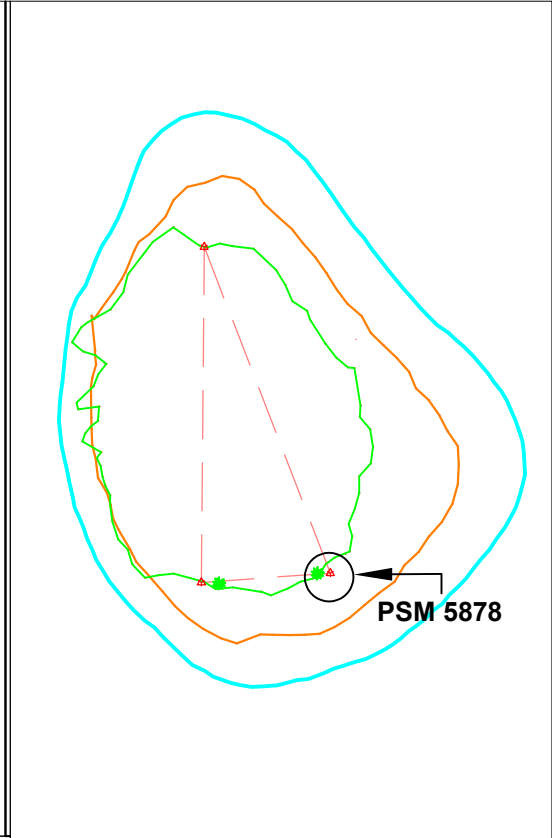
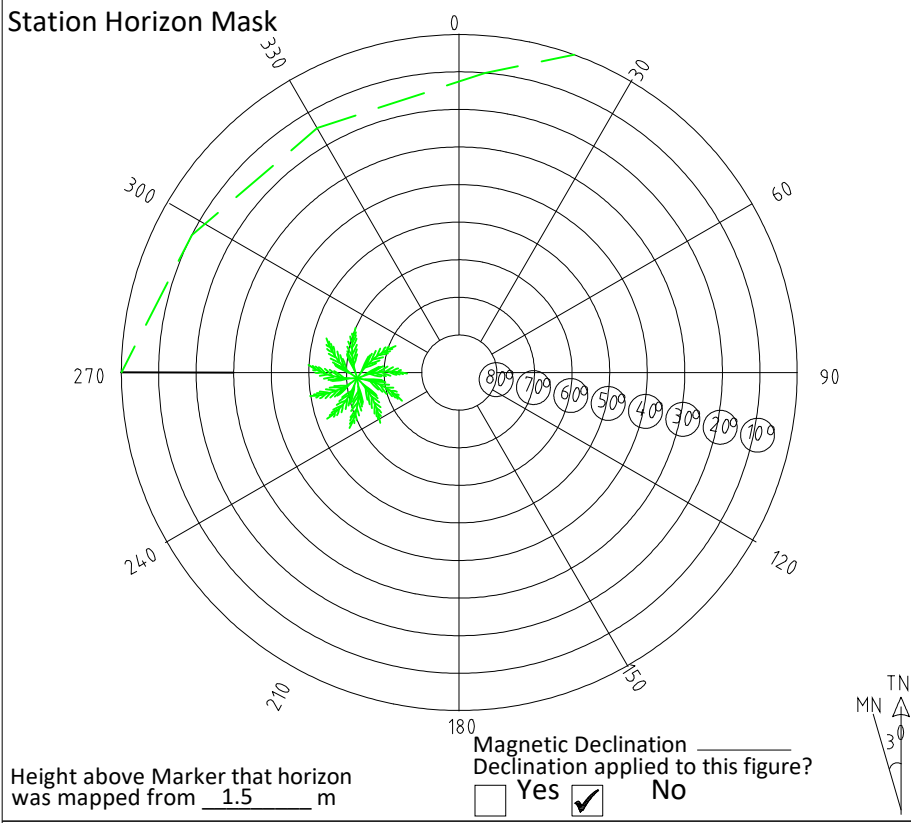

Sketched by: AHMED                      Scale: Not to Scale                      Date: 25th OCTOBER 2022

# MALDIVES LAND SURVEY AUTHORITY

MINISTRY OF HOUSING AND INFRASTRUCTURE  
 Office (PABX): +(960) 3004300, Fax: +(960) 3004254  
 Email: survey@housing.gov.mv  
 Web: www.surveyofmaldives.gov.mv,  
 Ameenee Magu, Maafannu, Male', 20392, Maldives.



CONTROL POINT DETAILS	Station Number	PSM 5879
Coordinate Information		
Geodetic	Grid	
WGS 84	UTM Zone 43	
Lat: 5°14'07.12903"N	E:	296981.448m
Long: 73°10'05.66620"E	N:	578971.797m
Ellp Height: -87.116	Orth Height:	+ 1.267
Island Name: B.Dhandhoo, Maldives	Date: 25th October 2022	

## Monument description & method of survey:

- Monument Type A as in Technical Brief
- Stainless steel plate fixed to concrete by Four bolts
- Horizontal coordinates fixed by GNSS Static survey.
- Elevation reduced relative to ellipsoid height difference, reference to PSM 5878 which was corrected to Meanwater level by tide prediction table ( Hulhule )
- PSM 5879 is at ground Level

## General site condition & access:

- Easily accessible area with wide angle of sky visibility
- Located at the south west side of the island
- Situated near vegetation line and no fixed structures or trees available to measure

Owner: DHANDHOO HOLDINGS PRIVATE LIMITED

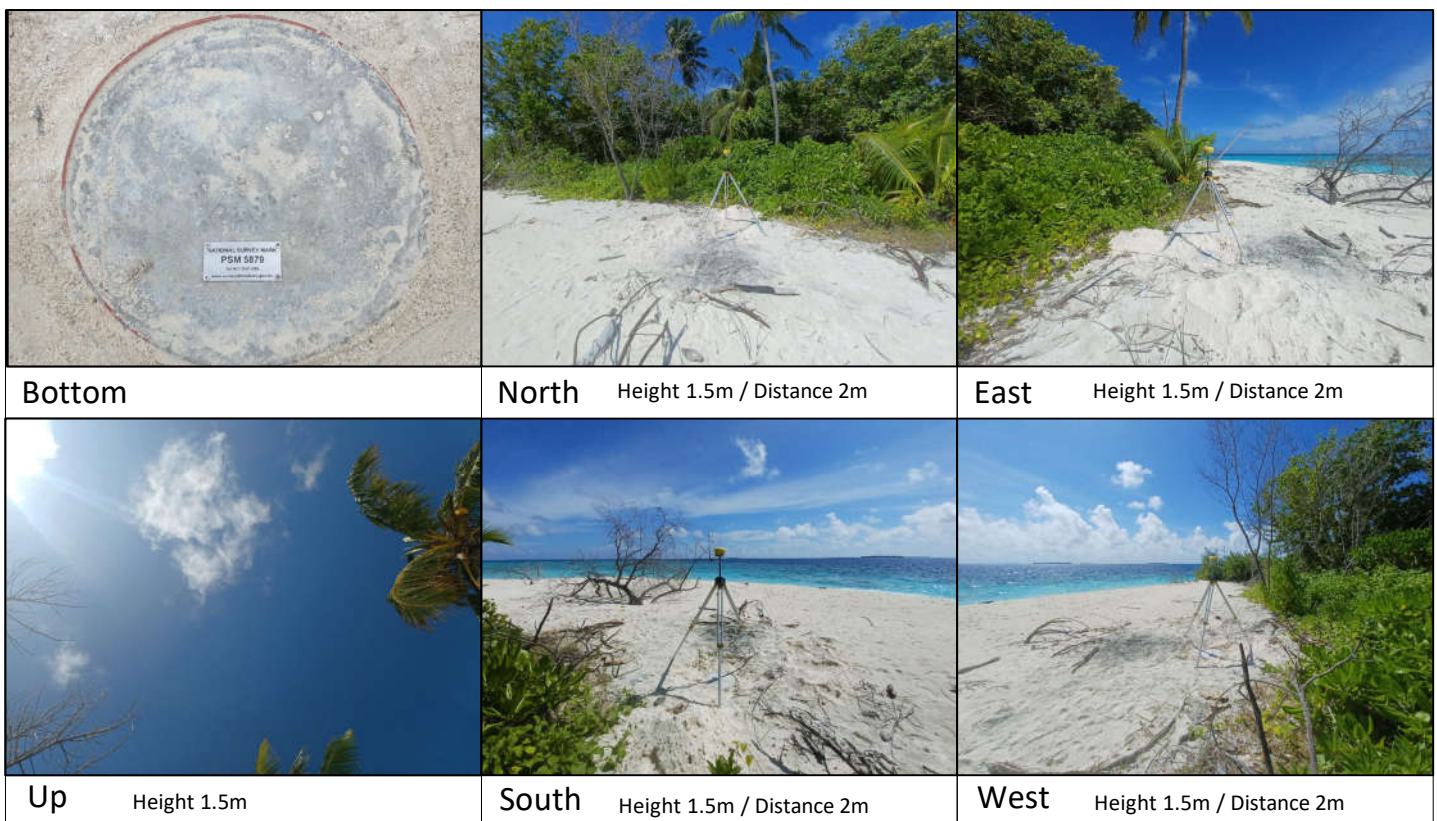



SITE INFORMATION

Station Number

P	S	M	5	8	7	9
---	---	---	---	---	---	---

Station Horizon Mask

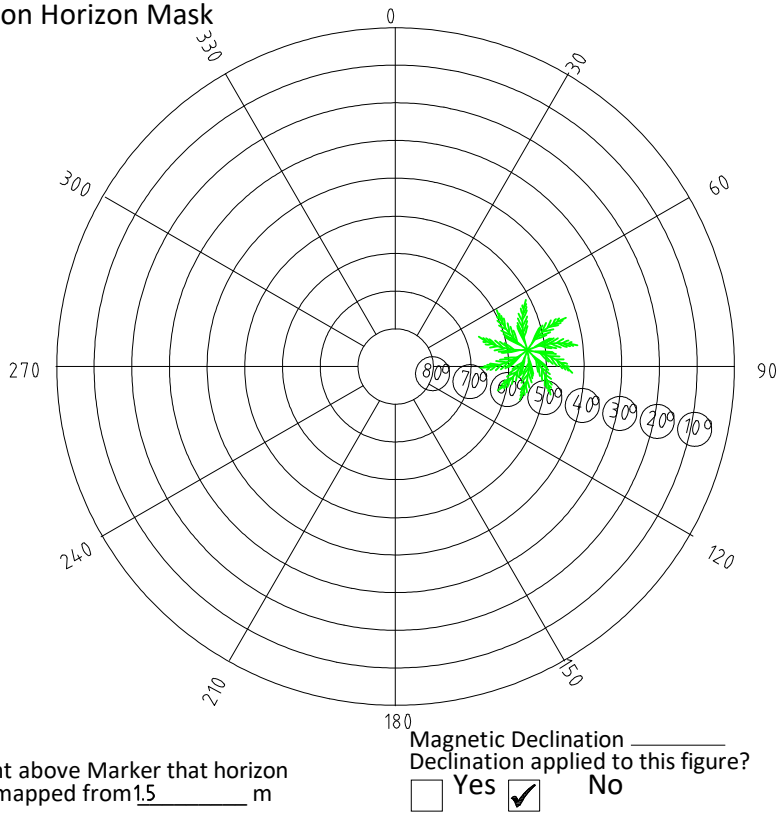

Height above Marker that horizon was mapped from 15 m

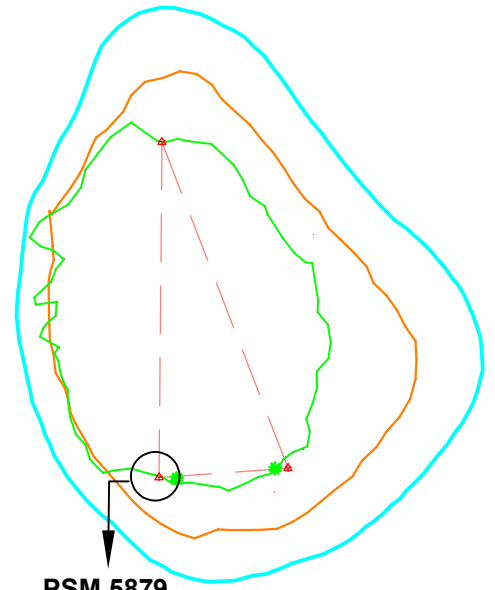

PSM 5879

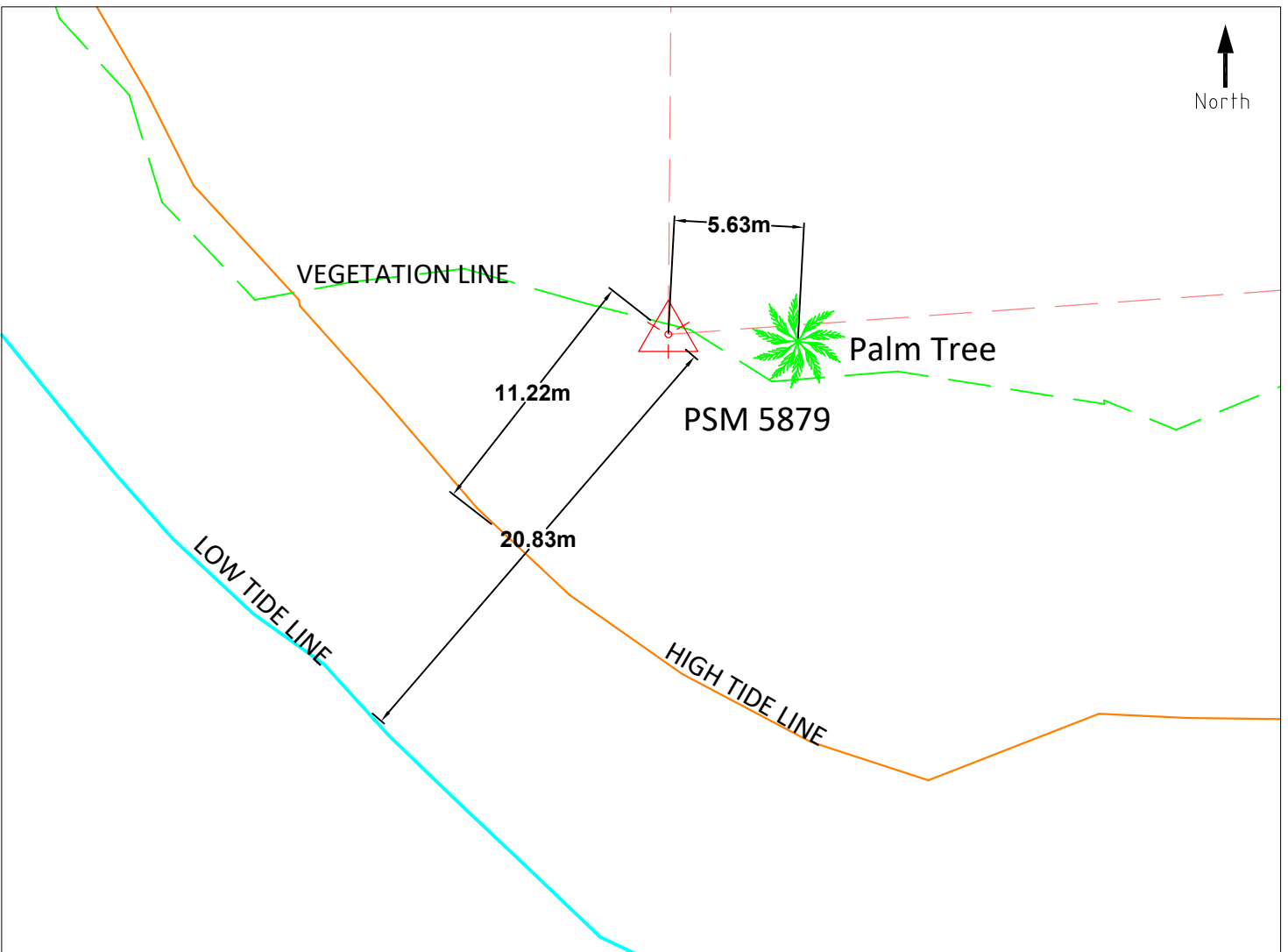

Sketched by: AHMED

Scale: Not to Scale

Date: 25th OCTOBER 2022

# MALDIVES LAND SURVEY AUTHORITY

MINISTRY OF HOUSING AND INFRASTRUCTURE  
 Office (PABX): +(960) 3004300, Fax: +(960) 3004254  
 Email: survey@housing.gov.mv  
 Web: www.surveyofmaldives.gov.mv,  
 Ameenee Magu, Maafannu, Male', 20392, Maldives.



CONTROL POINT DETAILS	Station Number	PSM 5880
Coordinate Information		
Geodetic	Grid	
WGS 84	UTM Zone 43	
Lat: 5°14'10.59302"N	E:	296982.322m
Long: 73°10'05.68449"E	N:	579078.212m
Ellp Height: -87.048	Orth Height:	+1.335
Island Name: B.Dhandhoo, Maldives	Date:	25th October 2022

### Monument description & method of survey:

- Monument Type A as in Technical Brief
- Stainless steel plate fixed to concrete by Four bolts
- Horizontal coordinates fixed by GNSS Static survey.
- Elevation reduced relative to ellipsoid height difference reference to PSM 5878 which was corrected to Meanwater level by tide prediction table.( Hulhule )
- PSM 5880 is at ground Level

### General site condition & access:

- Easily accessible area with wide angle of sky visibility
- Located at the North side of the island
- Situated on north side vegetation line and no fixed structures or trees available to measure

Owner: DHANDHOO HOLDINGS PRIVATE LIMITED

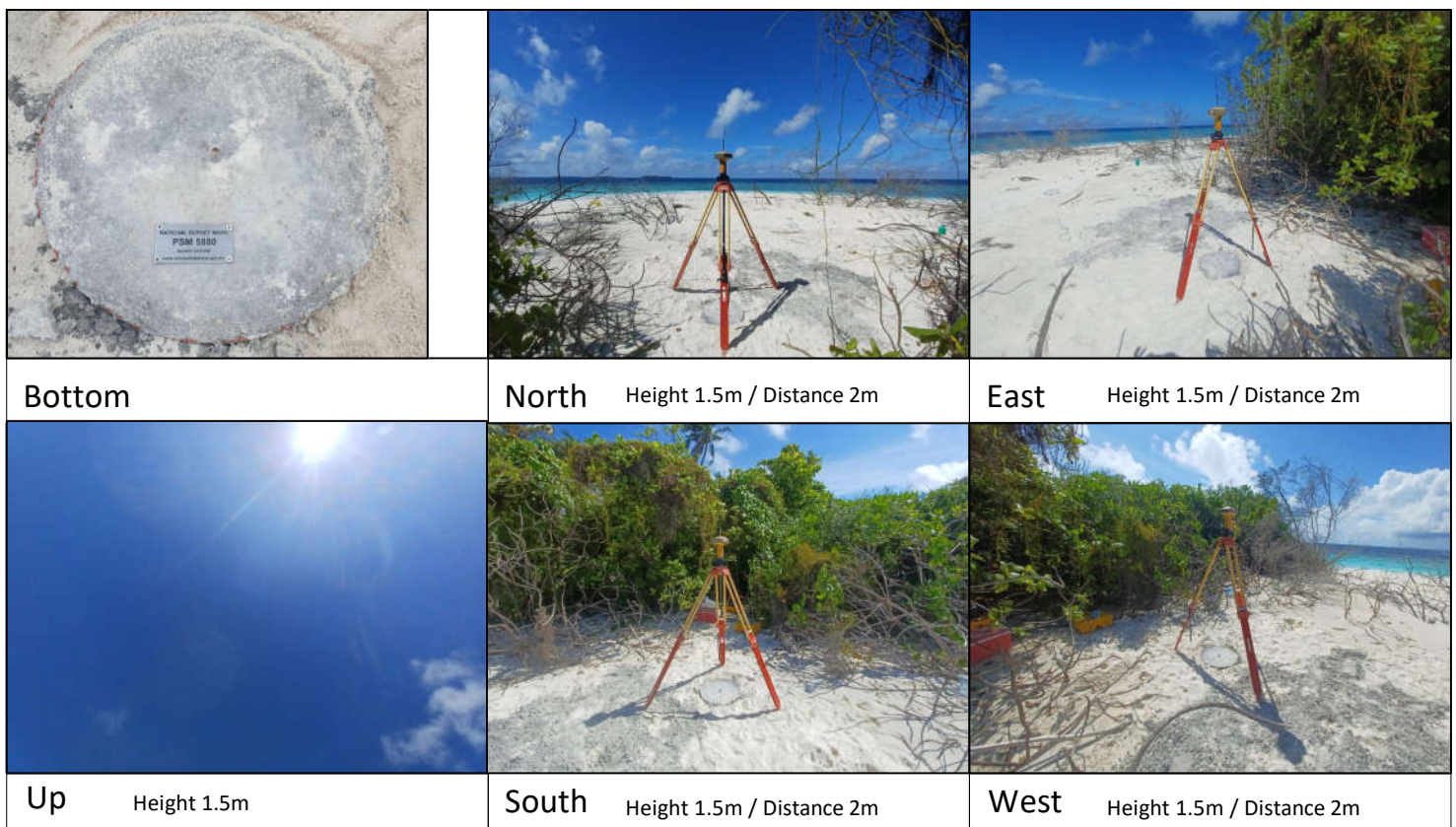

SITE INFORMATION

Station Number

P	S	M	5	8	8	0
---	---	---	---	---	---	---

Station Horizon Mask

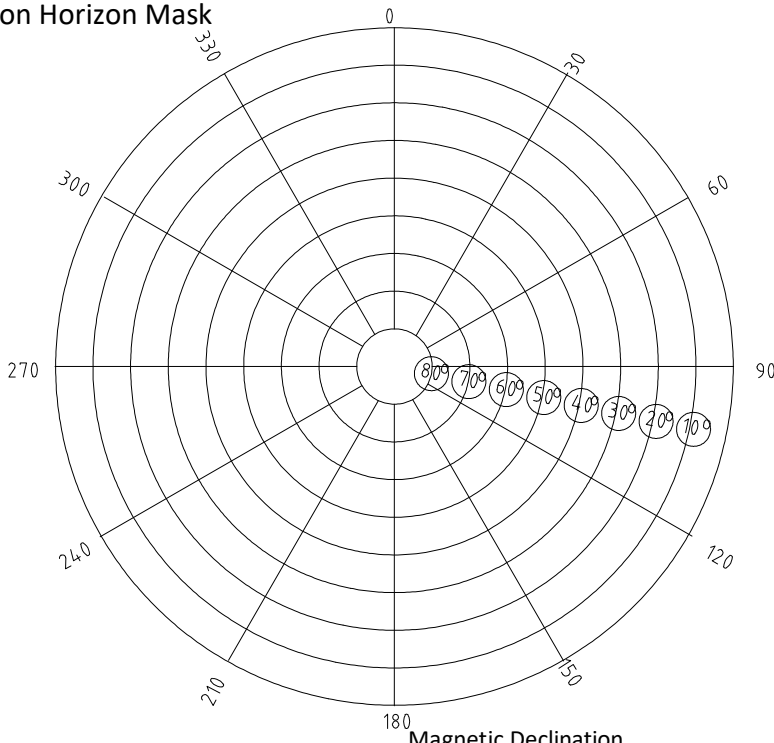

Height above Marker that horizon was mapped from 1.5 m

Magnetic Declination Declination applied to this figure?  
 Yes  No

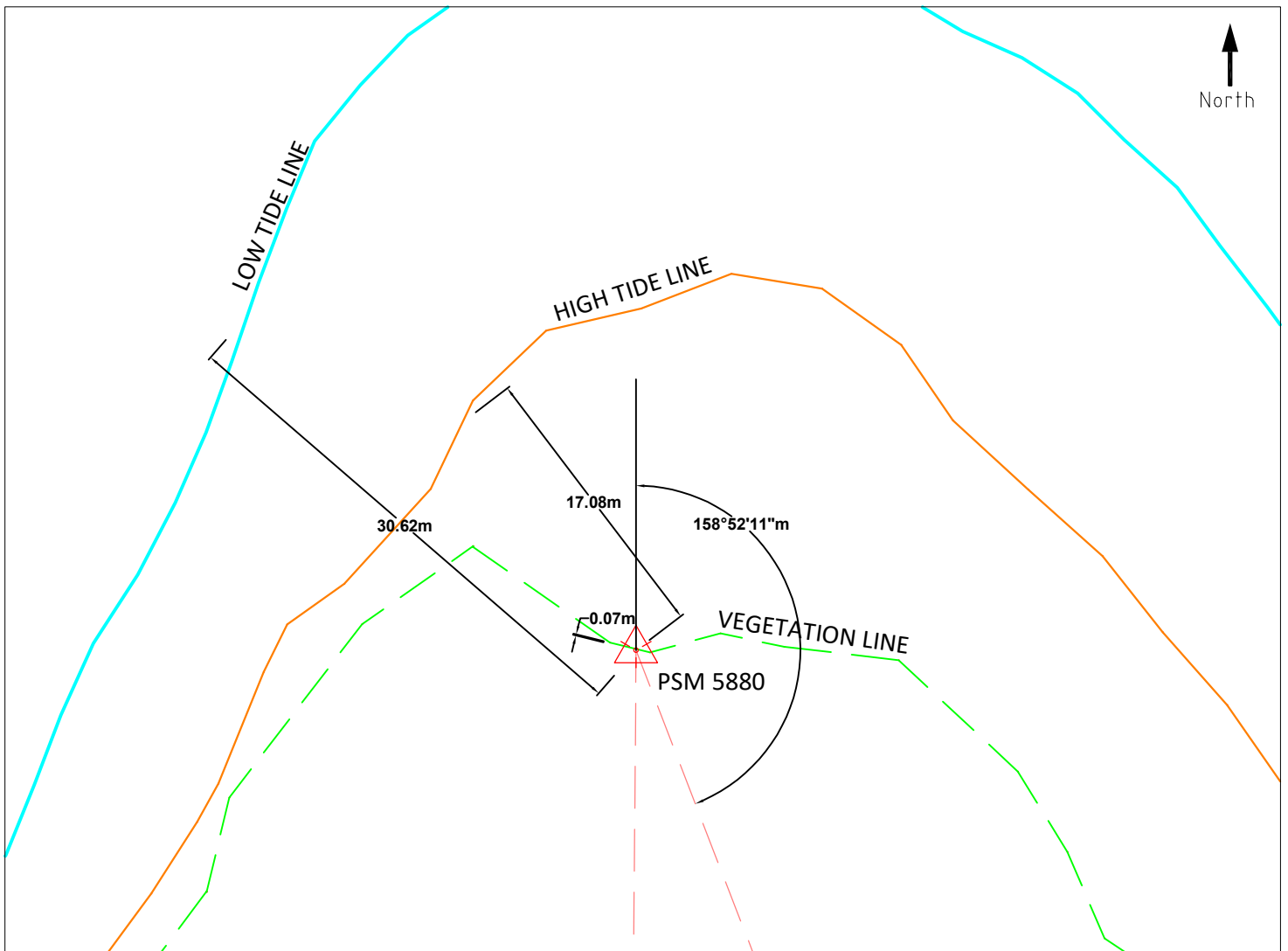
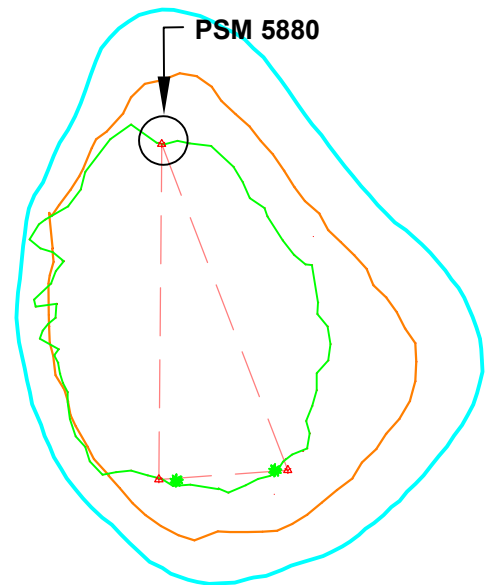

Sketched by: AHMED

Scale: Not to Scale

Date: 25th OCTOBER 2022