



CONTROL POINT DETAILS		Station Number	PSM 0179
Coordinate Information			
Geodetic		Grid	
WGS 84		UTM Zone 43	
Long: 73°28'06.34626"E		E: 330187.162	
Lat: 4°57'18.01603"N		N: 547886.632	
Ellp Height: -85.782		Orth Height: +0.770	
Island Name: K.Kaashidhoo		Date: 7/11/2017	

*Monument description & method of survey:*

- Concrete casted in 300mm wooden box, length measuring 1000mm buried below ground, 1m s/s rod driven into the concrete as the center mark. Monument labeled with s/s plate stating point ID.
- Below 20mm.
- GNSS static survey post processing.
- PSM elevation relative to the reduced elevation of PSM0180.

*General site condition & access:*

- Located towards south eastern side of the island, facing the existing road (Haveeree Hingun) infront to the entrance of the waste disposal area.
- Easy access.

*Owner: K.Kaashidhoo Council*



# SITE INFORMATION

Station Number

P

S

M

0

1

7

9

Station Horizon Mask

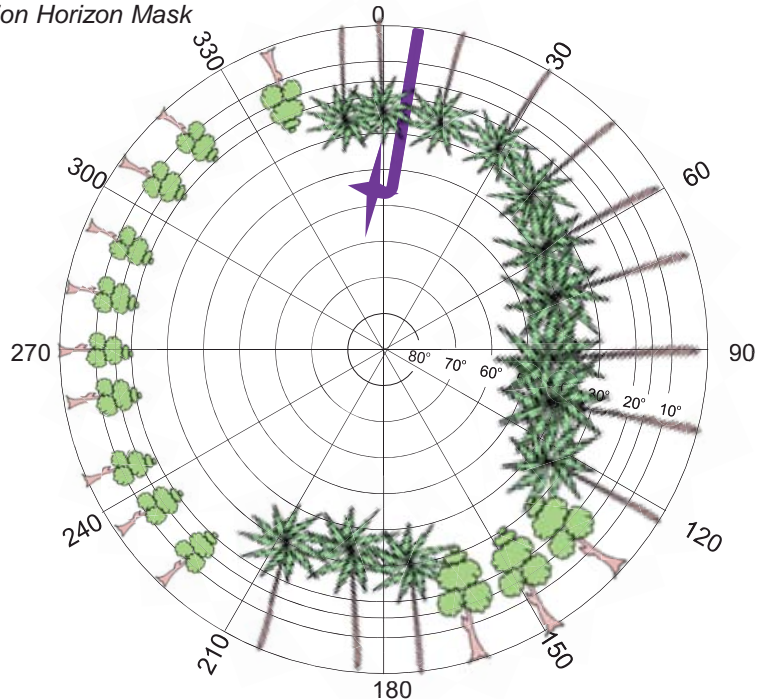

Locality



Height above Marker that horizon was mapped from 1.5 m

Magnetic Declination  
Declination applied to this figure?  
☐ Yes ☒ No

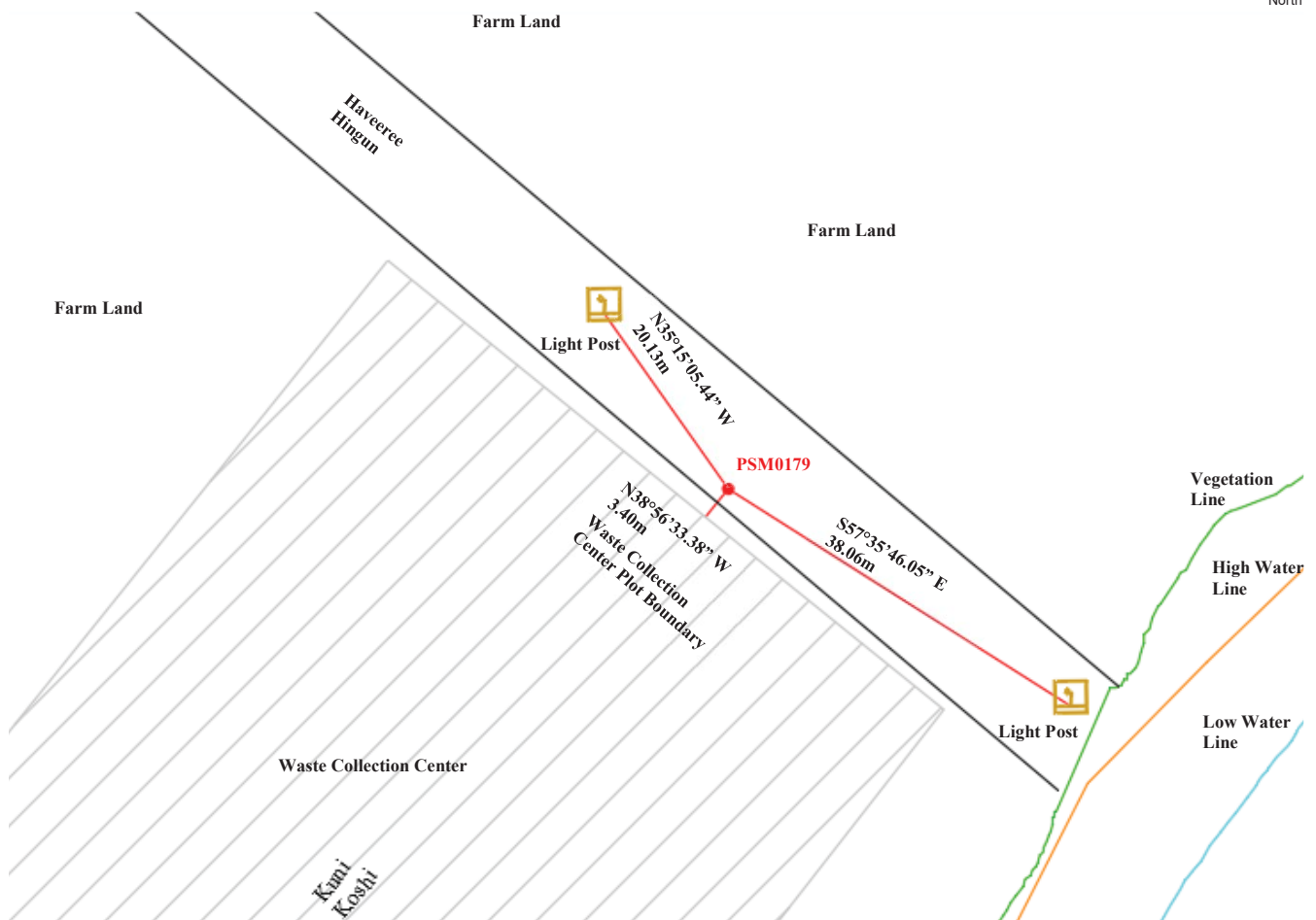

Sketched by: Ahmed Mohamed

Scale: Not to scale

Date: 07/11/2017





CONTROL POINT DETAILS		Station Number	PSM 0180
Coordinate Information			
Geodetic		Grid	
WGS 84		UTM Zone 43	
Long: 73°27'38.31688"E		E: 329325.003	
Lat: 4°57'36.41374"N		N: 548453.737	
Ellp Height: -85.565		Orth Height: +0.987	
Island Name: K.Kaashidhoo		Date: 7/11/2017	

*Monument description & method of survey:*

- Concrete casted in 300mm wooden box, length measuring 1000mm buried below ground, 1m s/s rod driven into the concrete as the center mark. Monument labeled with s/s plate stating point ID.
- Below 20mm.
- GNSS static survey post processing.
- Vertical control, PSM elevation reduced with reference to MSL with reference to tide prediction data of Hulhule' Tide station.

*General site condition & access:*

- Located towards north west of the island, south side of the harbor which can be accessed via the Beach Road.
- Easy access.

*Owner: K.Kaashidhoo Council*

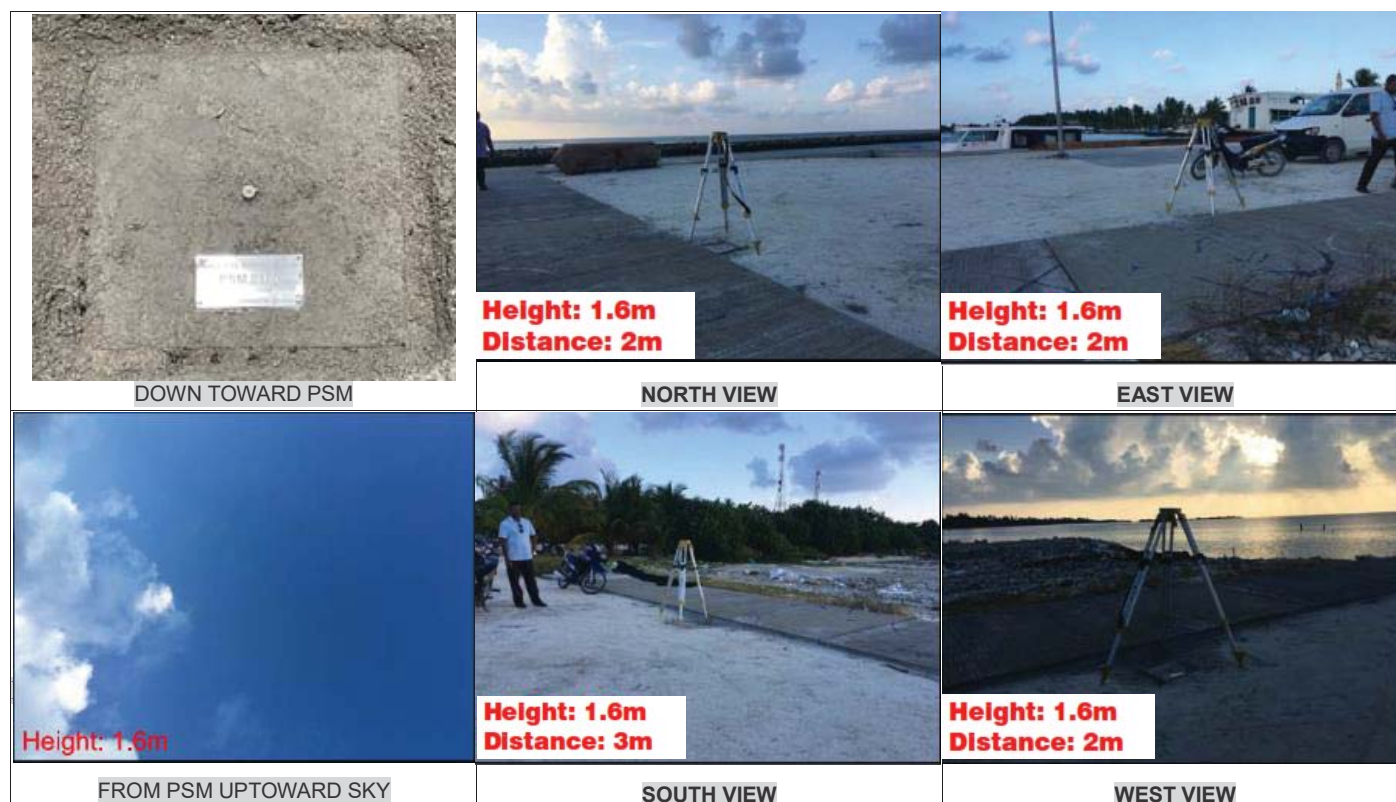

# SITE INFORMATION

Station Number

P S M 0 1 8 0

Station Horizon Mask

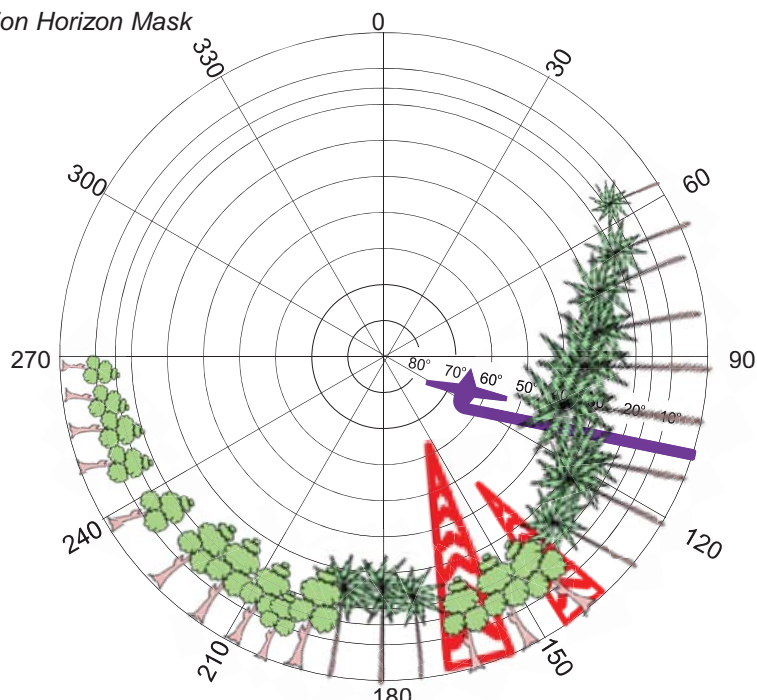

Height above Marker that horizon was mapped from 1.5 m

Magnetic Declination -----  
Declination applied to this figure?  
☐ Yes ☒ No

Locality

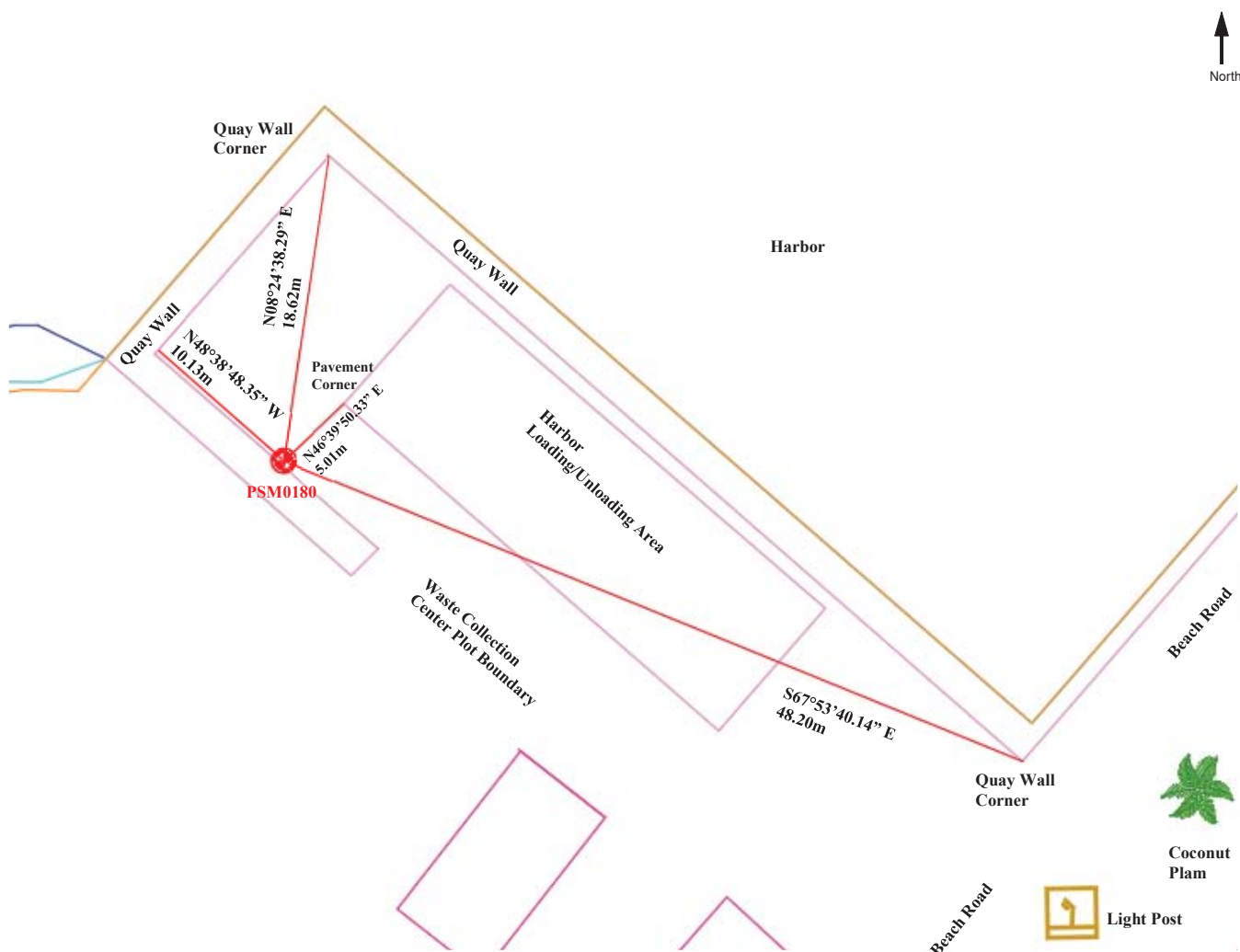
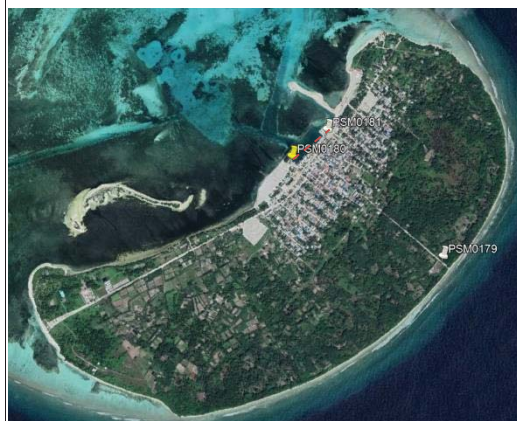

Sketched by: Ahmed Mohamed

Scale: Not to scale

Date: 07/11/2017



CONTROL POINT DETAILS		Station Number	PSM 0181
Coordinate Information			
Geodetic		Grid	
WGS 84		UTM Zone 43	
Long: 73°27'44.92903"E		E: 329529.046	
Lat: 4°57'41.33558"N		N: 548604.443	
Ellp Height: -85.630		Orth Height: +0.922	
Island Name: K.Kaashidhoo		Date: 7/11/2017	

*Monument description & method of survey:*

- Concrete casted in 300mm wooden box, length measuring 1000mm buried below ground, 1m s/s rod driven into the concrete as the center mark. Monument labeled with s/s plate stating point ID.
- Below 20mm.
- GNSS static survey post processing.
- PSM elevation relative to the reduced elevation of PSM0180.

*General site condition & access:*

- Located towards north west of the island, north side of the harbor, on the beach road.
- Easy access.

*Owner: K.Kaashidhoo Council*

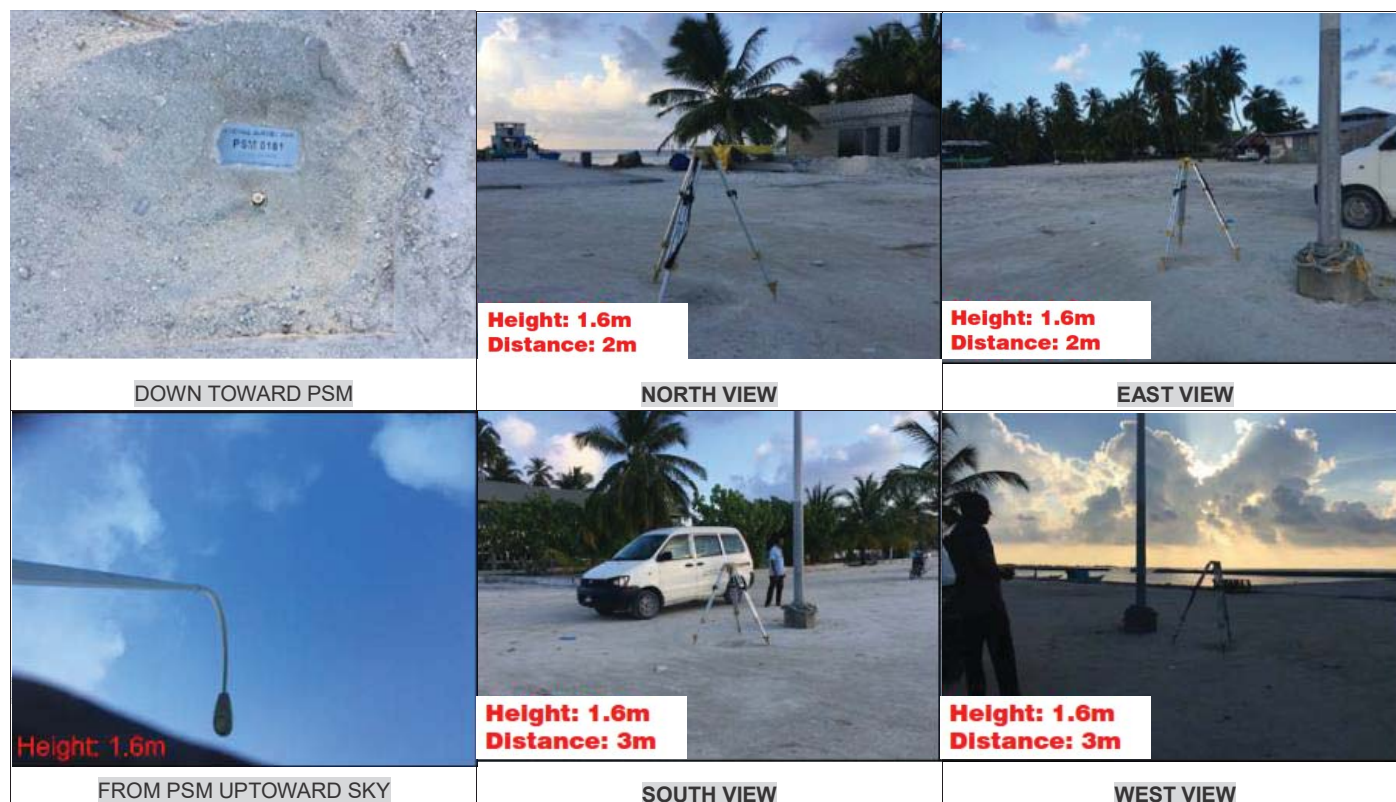



# SITE INFORMATION

Station Number

P S M 0 1 8 1

Station Horizon Mask

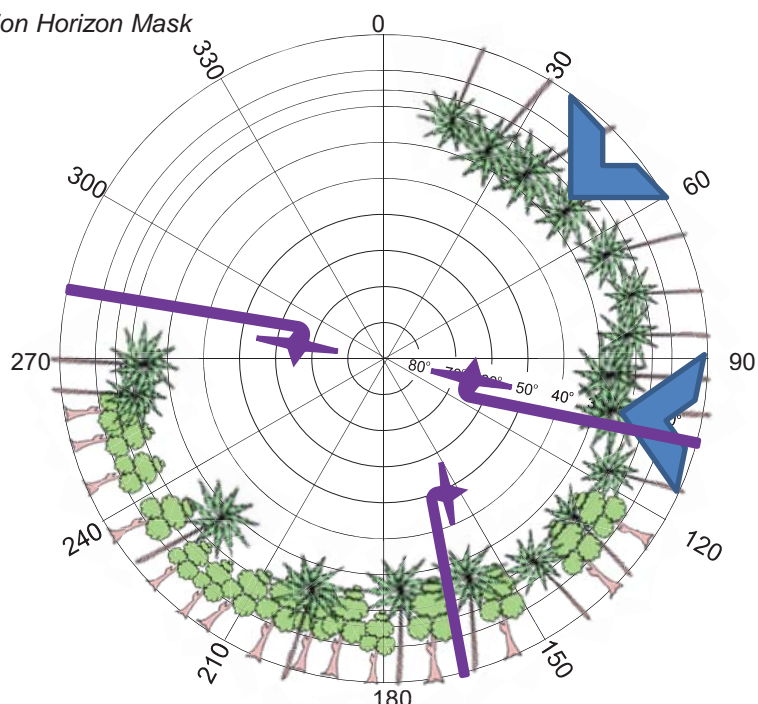

Height above Marker that horizon was mapped from 1.5 m

Magnetic Declination -----  
Declination applied to this figure?  
☐ Yes ☒ No

Locality

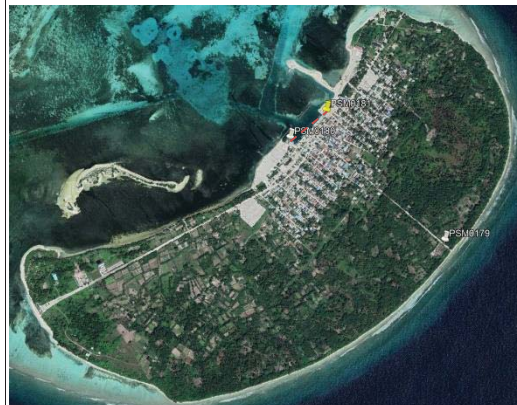

Sketched by: Ahmed Mohamed

Scale: Not to scale

Date: 07/11/2017