



CONTROL POINT DETAILS	Station Number
	PSM 0211
Coordinate Information	
Geodetic	Grid
WGS 84	UTM Zone 43
Lat: 6°25'56.77467"	22222222
Long: 73°04'12.77630"	11101000
Ellipsoid Height: 0	Orth Height: 1.21
Island Name: Sh.Noomara	Date: 20/02/2022

#### Monument description & method of survey:

- Concrete marked in 0000 code, length bearing 1000, carried along ground 1m, rod driven into the concrete at the center of the monument labeled with plate stating point ID
- 100m along ground
- GPS stationing point
- Vertical control PSM elevation reduced to MSL with reference to tide data provided by Meteorological Department

#### General site condition & access:

- Located at east side of the island at the south end of the harbor
- Accessable

Owner: Sh. Noomara Council

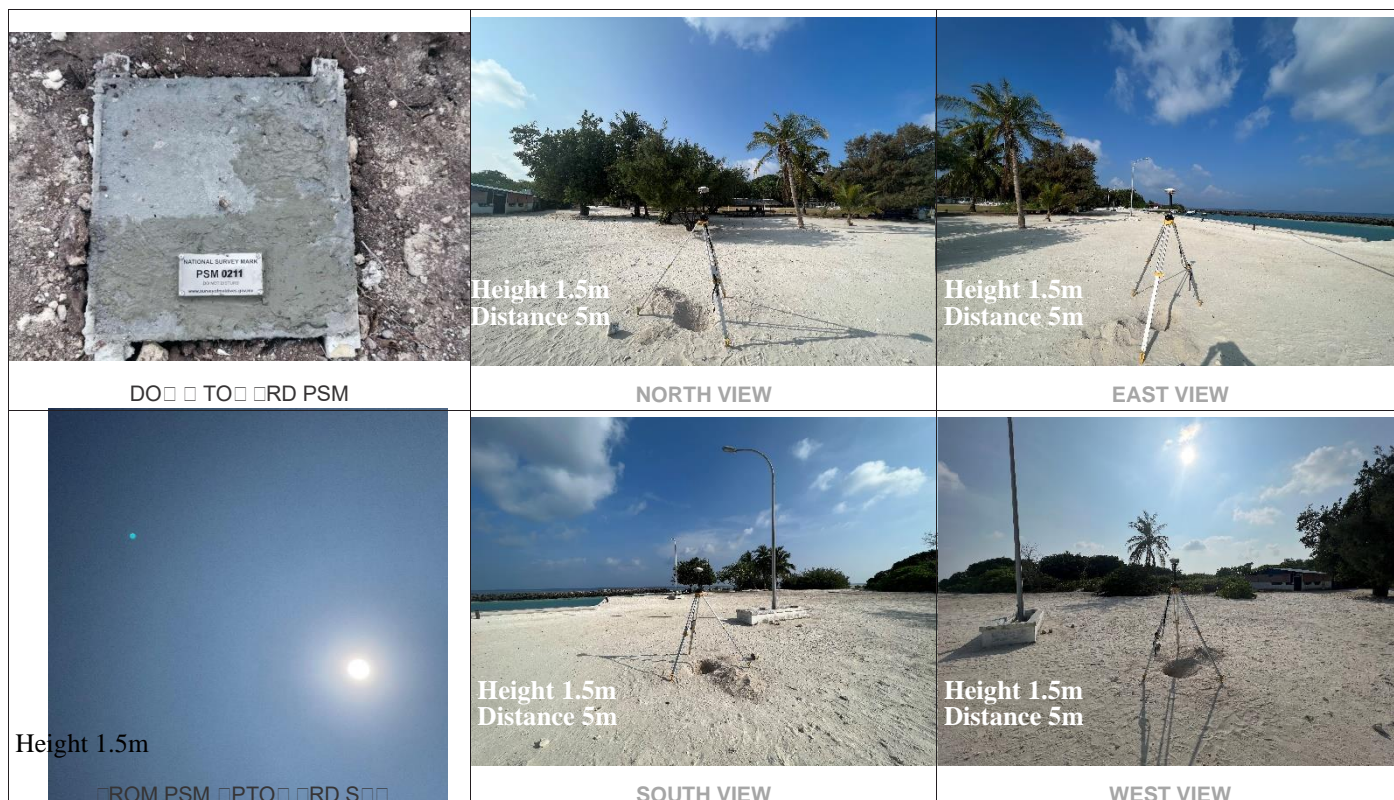

# SITE INFORMATION

Station Number

P S M 0 2 1 1

Station Horizon Mask

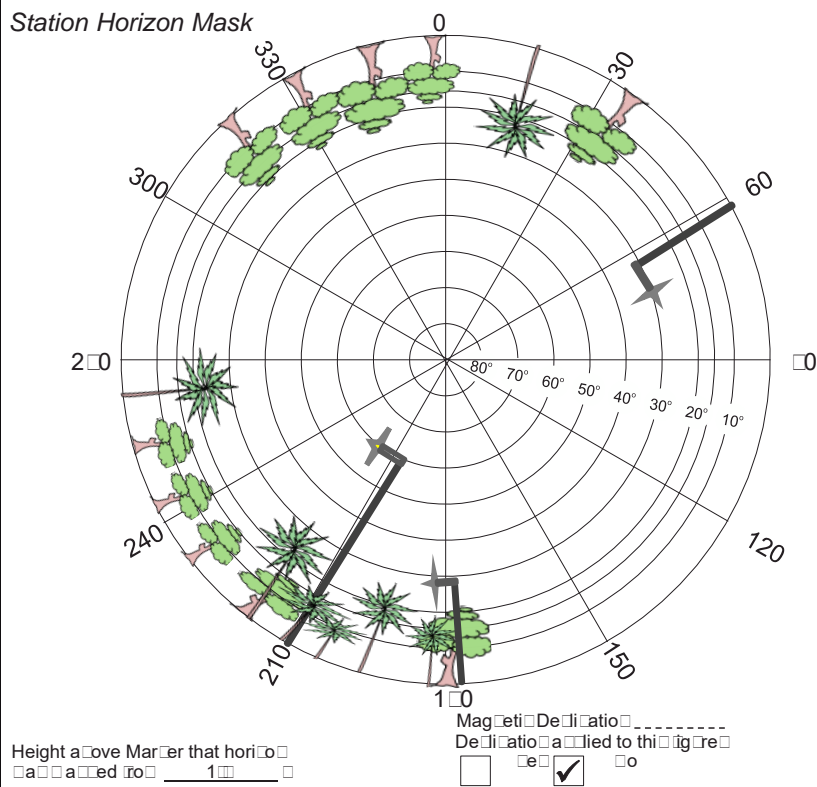

Locality



North

Bodu Magu

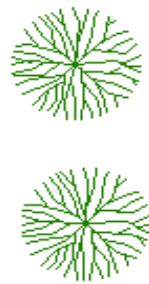

Palm Tree

Light Post

PSM0211

4.49m

Light post

11.50m

19.54m

Quay Wall

12.41m



North

Sketch of Mohamed Aeech

Scale of 1:1000

Date 20/02/2022

Maldives Land and Survey Authority, MINISTRY OF NATIONAL PLANNING, HOUSING & INFRASTRUCTURE, Ameene Magu, Maafannu, Male', 20392, Maldives, Office

(PABX): +(960) 3004300, Fax: +(960) 3004254, Email: [survey@housing.gov.mv](mailto:survey@housing.gov.mv), Web: [www.surveyofmaldives.gov.mv](http://www.surveyofmaldives.gov.mv)





CONTROL POINT DETAILS		Station Number	PSM 0212
Coordinate Information			
Geodetic		Grid	
WGS 84		UTM Zone 43	
Latitude 2° 00' 00" N		2 00 00 N	
Longitude 100° 10' 00" E		100 10 00 E	
Height 2.00 m		Orth Height 1.50 m	
Island Name: Sh. Noomara		Date: 20/02/2022	

**Monument description & method of survey:**

- Concrete marked in 0000 code, length bearing 1000m, buried below ground 1m, rod driven into the concrete at the center of the monument labeled with the date of setting and ID.
- 100m below ground
- GSS stationing point
- Vertical height relative to PSM0211

**General site condition & access:**

- Located at east side of the island at the north end of the harbor
- Accessable

Owner: Sh. Noomara Council.



DO NOT TO MOVE PSM

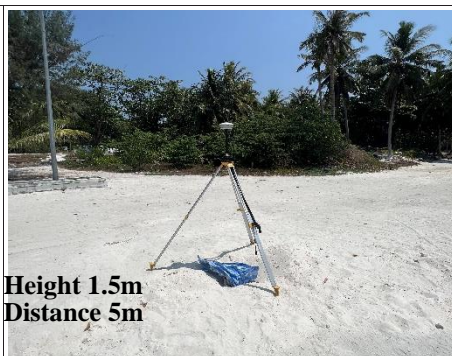

NORTH VIEW



EAST VIEW



FROM PSM POINT OF VIEW



SOUTH VIEW



WEST VIEW

# SITE INFORMATION

Station Number

P S M 0 2 1 2

Station Horizon Mask

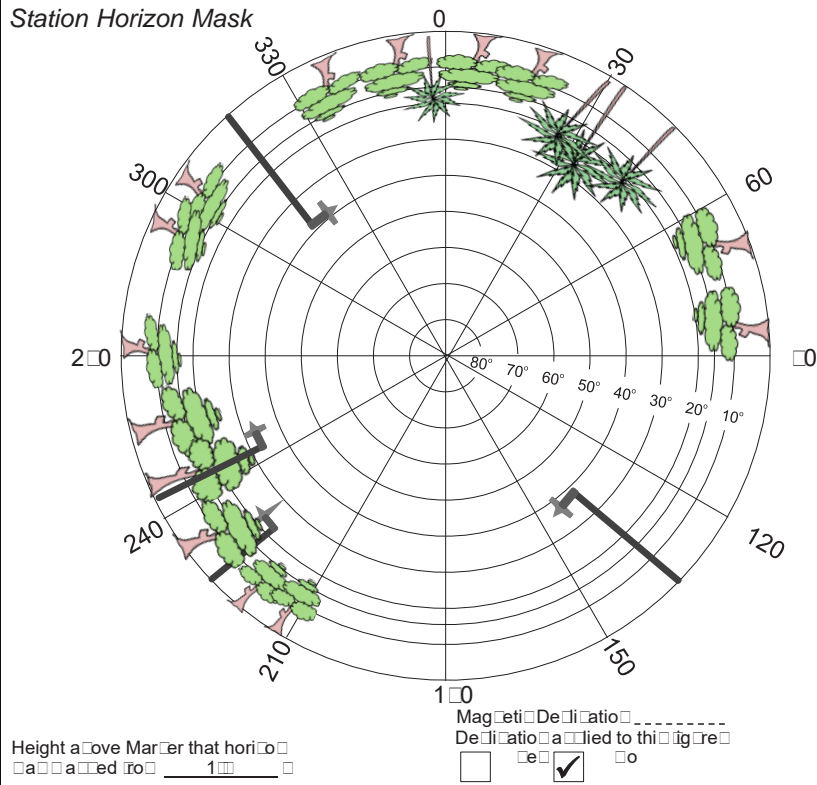

North

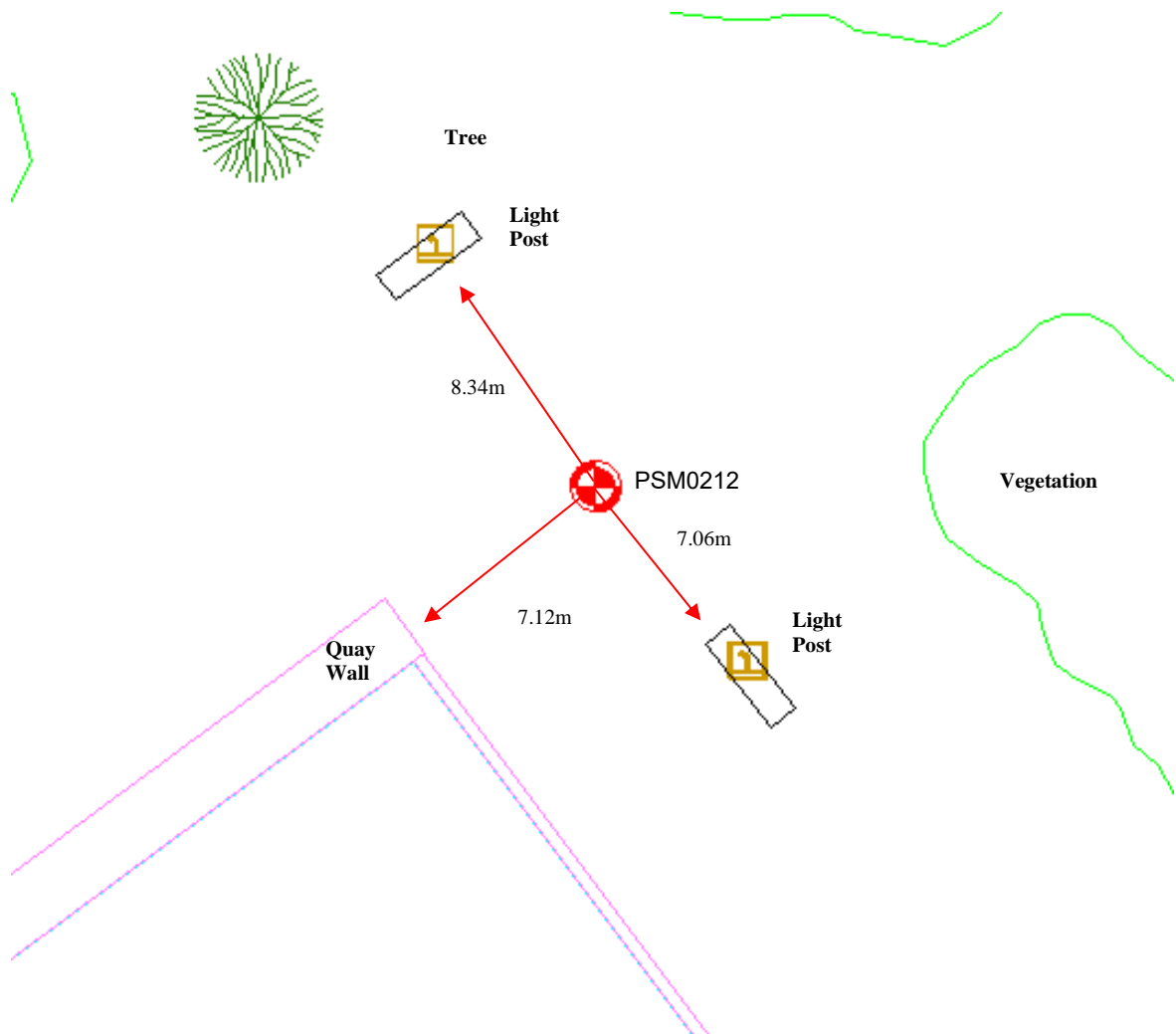

Sketches of the site

Scale of the site

Date 2022

Maldives Land and Survey Authority, MINISTRY OF NATIONAL PLANNING, HOUSING & INFRASTRUCTURE, Ameenah Magu, Maafannu, Male', 20392, Maldives, Office

(PABX): +(960) 3004300, Fax: +(960) 3004254, Email: [survey@housing.gov.mv](mailto:survey@housing.gov.mv), Web: [www.surveyofmaldives.gov.mv](http://www.surveyofmaldives.gov.mv)



CONTROL POINT DETAILS		Station Number	PSM 021
Coordinate Information			
Geodetic		Grid	
WGS 84		UTM Zone 43	
Lat 6°26'08.68107"		20000200	
Long 73°04'04.30335"		11000200	
Height 21		Orth Height 12	
Island Name: Shoomara		Date: 2022	

Monument description & method of survey:

- Concrete fixed in 100mm concrete base length bearing 1000mm fixed below ground 1mm rod driven into the concrete at the center of the monument labeled with plate stating point ID
- 100mm below ground
- GSS stationing point marking
- Vertical height relative to PSM0211

General site condition & access:

- Located at east end of road Mag
- Accessable

Owner: Sh.Noomara Council.



DO TO RD PSM



Height 1.5m  
Distance 5m

NORTH VIEW



Height 1.5m  
Distance 5m

EAST VIEW

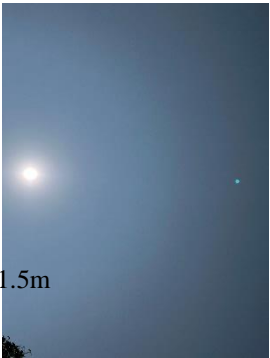

Height 1.5m

FROM PSM TO RD S



Height 1.5m  
Distance 5m

SOUTH VIEW



Height 1.5m  
Distance 5m

WEST VIEW



# SITE INFORMATION

Station Number

P S M 0 2 1 3

Station Horizon Mask

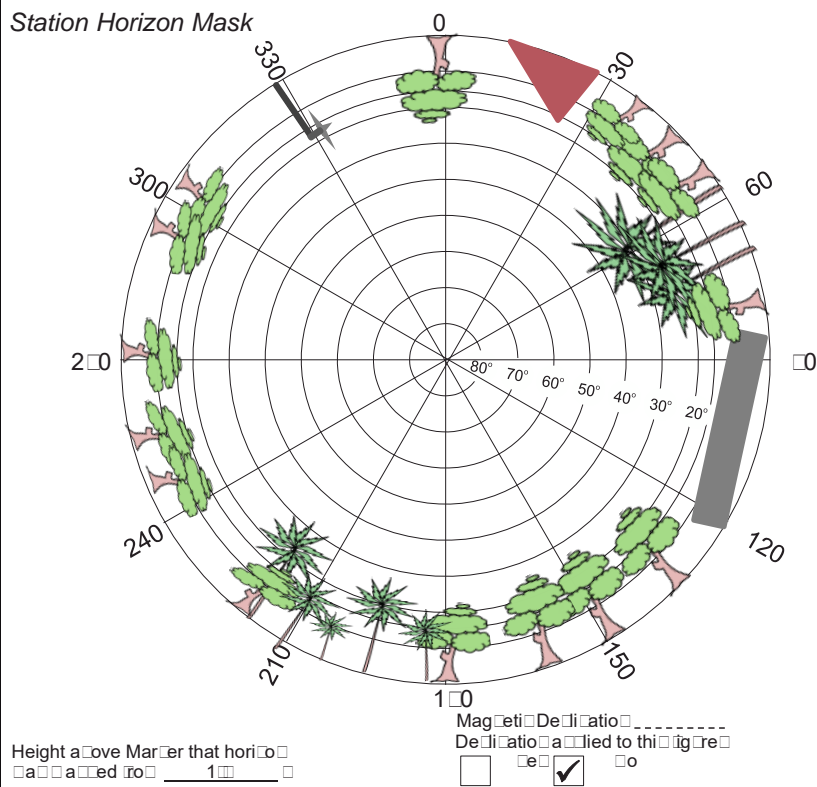

Locality



North

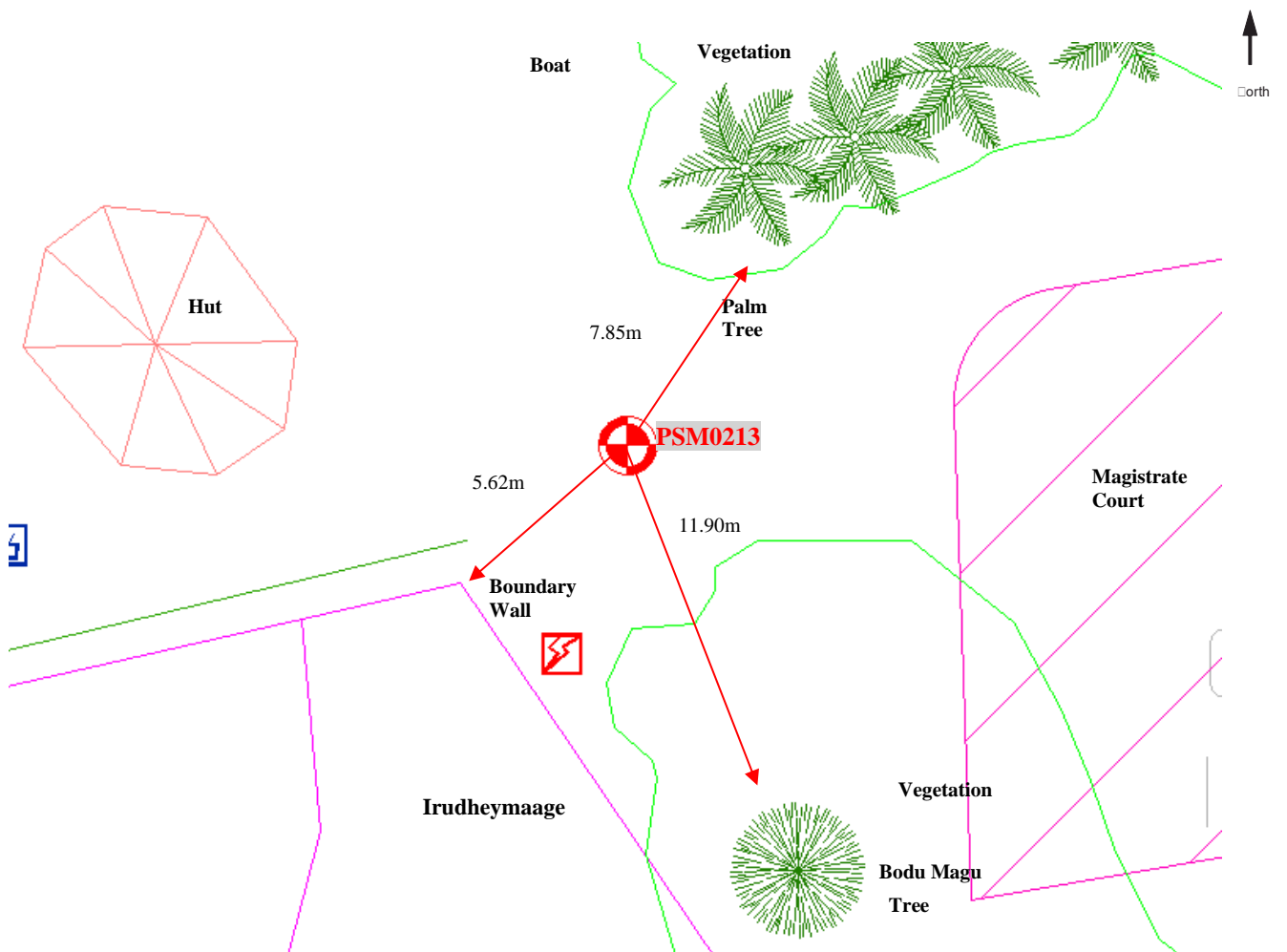

Settled / Mohaned / aeeh

Scale / Not to scale

Date / 2022

Maldives Land and Survey Authority, MINISTRY OF NATIONAL PLANNING, HOUSING & INFRASTRUCTURE, Ameene Magu, Maafannu, Male', 20392, Maldives, Office

(PABX): +(960) 3004300, Fax: +(960) 3004254, Email: [survey@housing.gov.mv](mailto:survey@housing.gov.mv), Web: [www.surveyofmaldives.gov.mv](http://www.surveyofmaldives.gov.mv)